



**PROPINK<sup>®</sup> High Performance  
Conditioned Attic System**  
Installation Guidelines



# PROPINK® High Performance Conditioned Attic System

Our new durable, high performance solution is designed to maximize the energy efficiency of the home by air sealing and insulating the attic. By adding thermal, air and moisture control at the roofline, the High Performance Conditioned Attic System delivers true R-Value to meet local codes.

- Provides uniform R-value with zero thermal bridges
- Constructed with Owens Corning® products proven to perform – ProPink One® Foam Sealant, ProPink™ Boxed Netting and ProPink® Loosefill Insulation
- Backed by Building Science, Owens Corning provides the best climatically-tuned solutions for the homes you build

## NOTE:

- The ProPink® High Performance Attic System is currently approved for use in climate zones 2B and 3B and is available with or without vapor retarder to meet climatic conditions.
- The UL Evaluation Services Report ER7108-01 is available for the Owens Corning® ProPink® High Performance Conditioned Attic System.

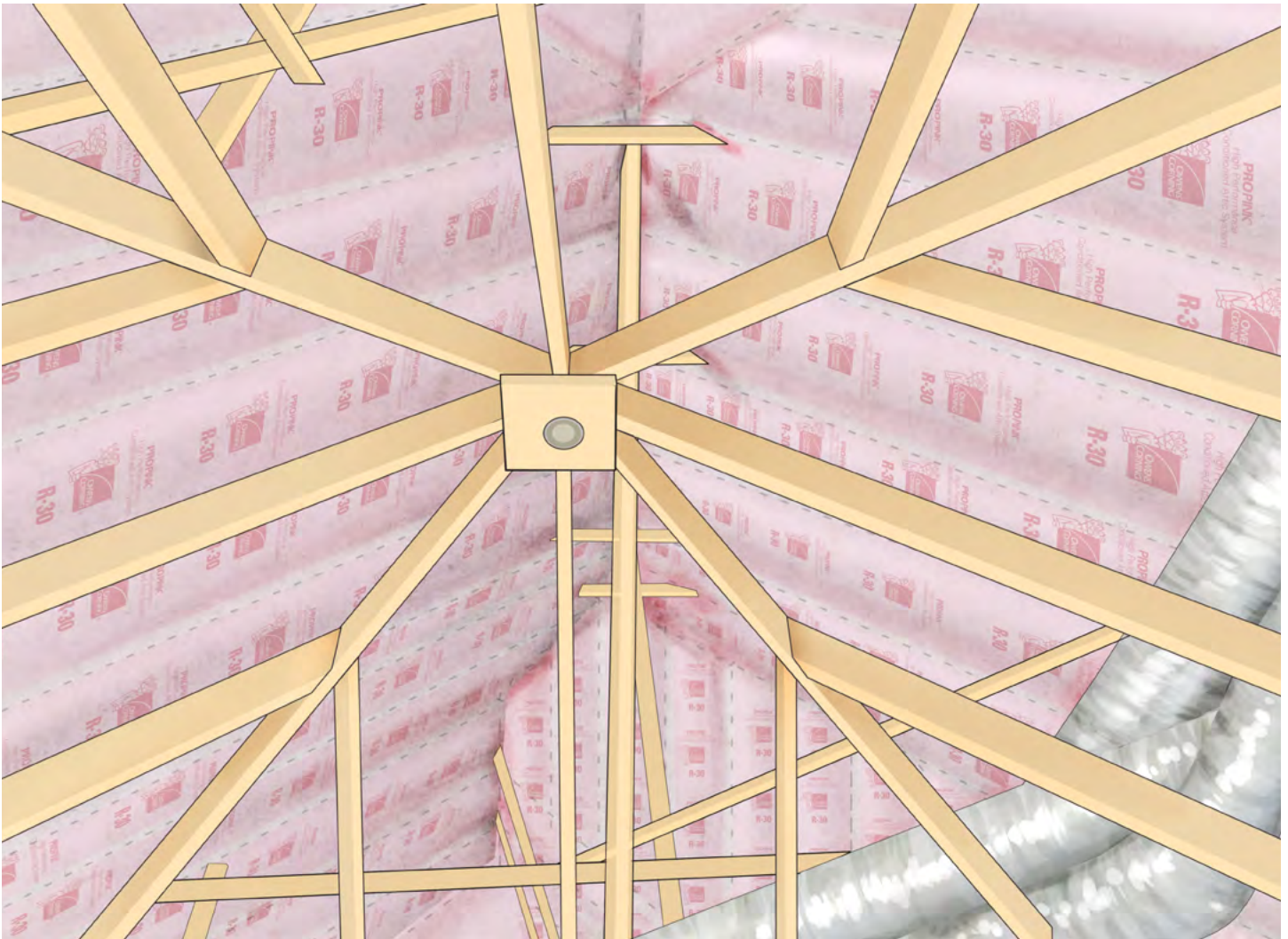

# High Performance Conditioned Attic System Construction Sequence

## Stage 1: Air Sealing

## Stage 2: Boxed Netting

## Stage 3: Insulation

### NOTE:

- **The air sealing/netting crew should be first into the attic** – immediately after the roof sheathing inspection and being “dried in” by having the roofing underlayment in place, but before HVAC, plumbing, and electric. This provides an unobstructed attic for the air sealing and netting installation.
- **The insulation crew should be last into the attic** – after HVAC, plumbing, electric, but before drywall. The crew comes prepared to air seal and repair netting caused by any penetrations.

---

## Personal Protective Equipment Requirements

The use of personal protective equipment in a construction area is very important to your safety

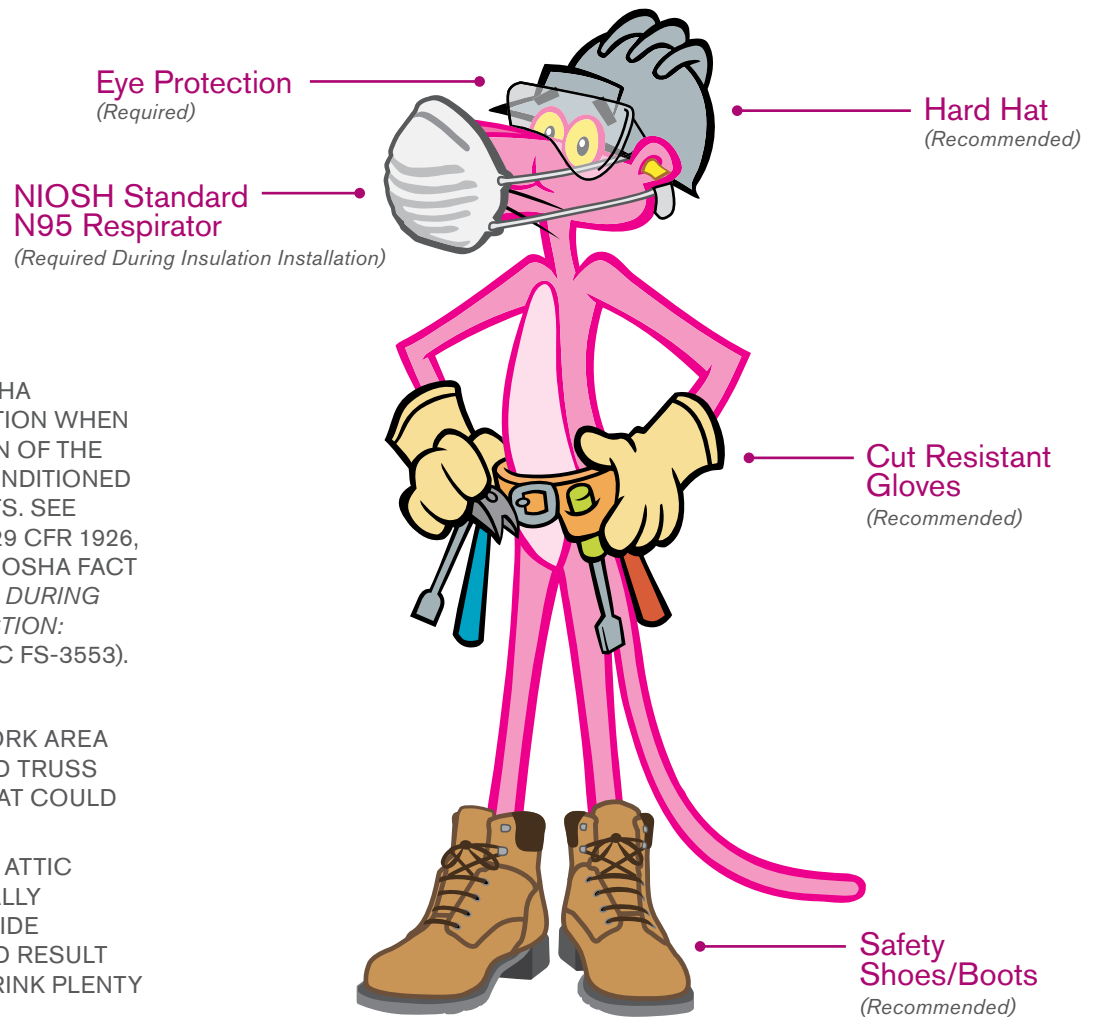

### Fall Protection

WORKERS MUST USE OSHA REQUIRED FALL PROTECTION WHEN INSTALLING ANY PORTION OF THE HIGH PERFORMANCE CONDITIONED ATTIC SYSTEM AT HEIGHTS. SEE OSHA REGULATIONS AT 29 CFR 1926, SUBPART M, AS WELL AS OSHA FACT SHEET: *REDUCING FALLS DURING RESIDENTIAL CONSTRUCTION: WORKING IN ATTICS* (DOC FS-3553).

### Other Precautions

**CUTS** — SURVEY THE WORK AREA FOR EXPOSED NAILS AND TRUSS CONNECTOR PLATES THAT COULD CAUSE A CUT.

**HOT CONDITIONS** — THE ATTIC ENVIRONMENT IS TYPICALLY HOTTER THAN THE OUTSIDE CONDITIONS AND COULD RESULT IN HEAT EXHAUSTION. DRINK PLENTY OF FLUIDS.

# Air Sealing Installation



## Job Checklist

- ProPink One® Foam Sealant
- Owens Corning® ProPink™ Eave Blocks
- Hammer stapler and staples
- Utility knife

## SAFETY

### Use of Owens Corning® ProPink One® Foam Sealant

- See general safety recommendations on page 3.
- This product is extremely flammable during dispensing and curing. Read precautions carefully.
- Use only in well ventilated areas. Wet chemical in the foam is isocyanate, which is hazardous. Provide sufficient cross ventilation to remove any buildup of vapors.
- Wear protective glasses or goggles, nitrile gloves, and clothing that protects against exposure to the skin.
- Read all instructions and safety information (SDS) prior to use of any product.
- Keep away from heat, sparks, and sources of ignition.
- Contents are under pressure. Do not puncture or incinerate. Do not place in hot water or near radiators, stoves, or other sources, or store above 120°F.

### Fasten Eave Block

Common areas in need of blocking include:

- Walls that adjoin the conditioned attic with an unconditioned space, such as above a garage
- Walls at the gable-end of the attic
- Excessive gaps around roof deck penetrations
- Eaves

Many eaves can be addressed with Owens Corning® ProPink™ Eave Blocks, which come pre-cut to fit in the space between the truss chords (22" width) and connect the wall's top plate to the frieze board (4.5" depth).

## 1. SET IN PLACE

Set the Eave Block in place such that it is resting flat on the top plate and making firm contact with the frieze board.

For truss chord spacing that is less than the standard 24" o.c., cut the Eave Block to the appropriate width. For a wider spacing, combine multiple Eave Blocks.

## 2. STAPLE

Fasten the Eave Block to the top plate with a minimum of five (5) staples (5/16" or longer).

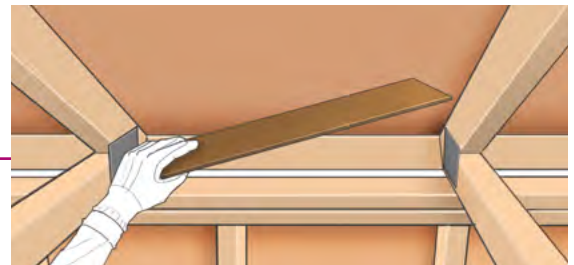

## Areas to Seal

### 1. ROOF DECK TRANSITIONS

Ridge, hips and valleys – Sealant is to be applied on both sides of the framing member that accompanies the transition.



### 2. EXPOSED SHEATHING JOINTS

Sealant is to be applied to all exposed roof deck sheathing joints.

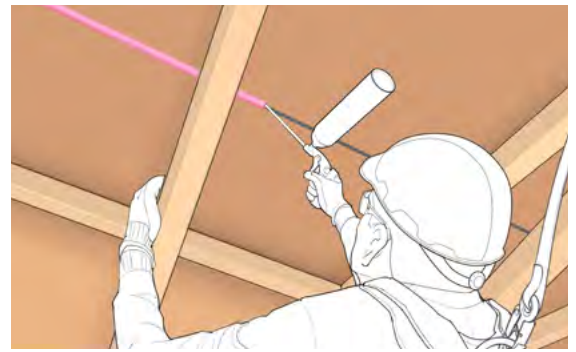

### 3. PENETRATIONS

All roof deck penetrations are to be flashed to the interior side of the roof deck such that the gap is 3/8" or less. The gap to the penetration is then to be sealed, as well as the perimeter of the flashing material.



### 4. EAVES

All joints at the eave are to be sealed. The quantity of joints could vary depending on the eave detail. For cases where the Eave Blocks are used, the following locations are to be sealed:

- Bottom plate to Eave Block
- Eave Block to frieze board
- Frieze board to roof deck
- Edges of Eave Block to truss chords
- Edges of frieze board to truss chords

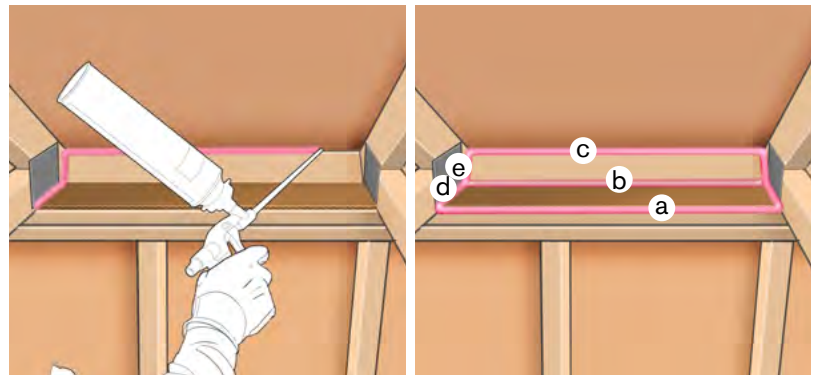

# Boxed Netting Installation



## Job Checklist

- Owens Corning® ProPink™ Boxed Netting
- Hammer stapler and staples (5/16", 20 ga.)
- Plier stapler and staples – .050 (wire width) x .019 (wire thickness) x 1/4" (leg length)
- Utility knife
- Ladder

## SAFETY

### Use of the Netting

- See general safety recommendations on page 3.
- Two or more pieces of netting laying on top of one another can be slippery. Use caution when stepping on netting.

### Material Storage:

Do not store the netting outdoors or in direct sunlight.

## Overview of the Boxed Netting System

### 1. HANG

Install individual pieces of netting, stapled to the face of the truss chords with the hammer stapler.



### 2. CONNECT

Gather adjacent pieces of netting at connecting tabs and fasten with a plier stapler to form a taut bottom.



### 3. BLOW

Fill the newly formed truss cavities with blown-in fiberglass of appropriate density to achieve desired R-value.



## Netting of Standard Width (24") Cavities

### HANG

#### Unroll, Secure and Cut

1. With the netting on the floor, **unroll** and thread netting from eave to eave
2. **Secure** netting to eave on far-side to top plate
3. **Secure** netting to ridge
4. Measure the length of netting required to produce a continuous bay from eave to eave, **cut**
5. **Secure** netting to eave on near-side to top plate

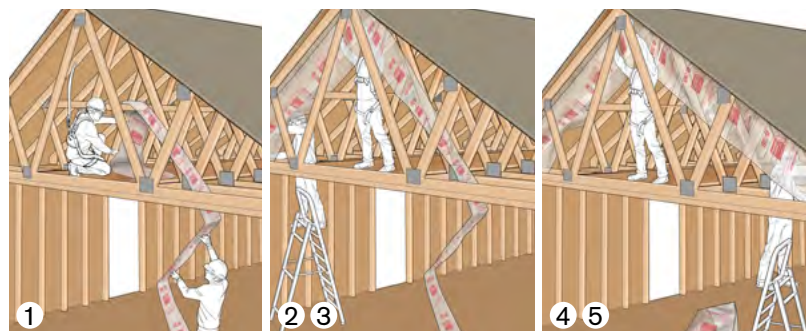

# Boxed Netting Installation

## Fasten netting to top truss chord

1. Align netting with the roof deck
2. Fasten netting along the top truss chord using staples a minimum of 2" from the roof deck
  - Staples should be applied to the face (3½" side) of the trusses and a maximum of **6" apart**
  - Netting orientation with respect to truss face should be maintained

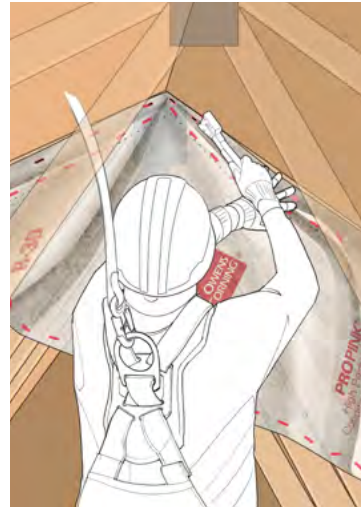

Ensure same orientation

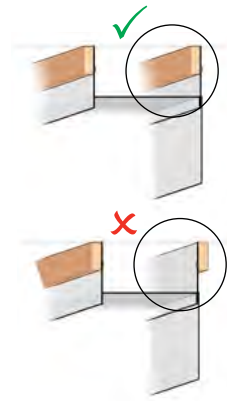

## CONNECT

1. Position the connecting tabs on adjacent pieces of netting
2. Staple the two connecting tabs together along the top of the seam, a maximum of **3" apart**
  - The bottom side of the netting should be tight, with no slack
3. At the eave, bunch the netting and hammer staple to the top plate
  - This step of fastening the netting at the eave is often best done immediately prior to the blowing step. This allows the other leads to have easy access to the top plate for wiring and piping penetrations



## Netting of Narrow Width (< 24") Cavities

### HANG

Fasten netting to top truss chord in the same manner as shown for standard width cavities

### CONNECT

1. Bunch up the extra netting inside of the cavity. Create a custom connecting tab by creasing the netting such that the bottom of the netting is tight when the created tab is stapled to the adjacent factory-made tab.
2. Staple the two connecting tabs together along the top of the seam, a maximum of **3" apart**
3. Finish netting install - The bottom side of the netting should be tight, with no slack

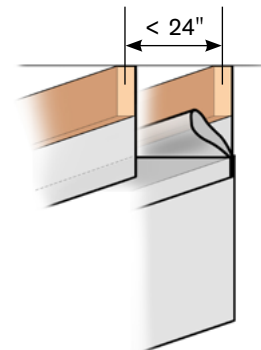

# Boxed Netting Installation

## Netting of Wide Width (> 24") Cavities

### HANG

1. When encountering wide width cavities (i.e greater than 24"), switch to the **Utility Roll (34" flap)**
2. Fasten utility netting to top truss chord in the same manner as shown for standard width cavities

### CONNECT

1. While pulling one side of the netting tight, bunch up the netting attached to the opposing side of the truss bay to determine the quantity of excess material
2. Create a custom connecting tab, bunching up the excess in the cavity
3. Staple the two connecting tabs together along the top of the seam, a maximum of **3" apart**
4. Finish netting install - The bottom side of the netting should be tight, with no slack

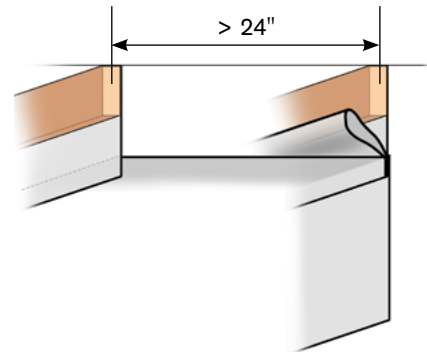

## Netting of Cavities at the Hip

### HANG

1. When encountering hips, due to the pitch of the roof, the distance between adjacent bays will increase even if the foot print of the trusses stay at the 24" spacing. See the table for the relationship between pitch and cavity width. Use the **Utility Roll** with an extra-wide flap (34") to meet this need. First, the installer needs to recognize that a different product is needed.
2. Fasten utility netting to top truss chord in the same manner as shown for standard width cavities

Pitch (x:12)	Cavity Width (in)
4	25.3
5	26.0
6	26.8
7	27.8
8	28.8
9	30.0
10	31.2
11	32.6
12	33.9

### CONNECT

1. Bunch up the extra netting inside of the cavity. Create a custom connecting tab by creasing the netting such that the bottom of the netting is tight when the created tab is stapled to the adjacent factory-made tab.
2. Staple the two connecting tabs together along the top of the seam, a maximum of **3" apart**
3. Finish netting install - The bottom side of the netting should be tight, with no slack

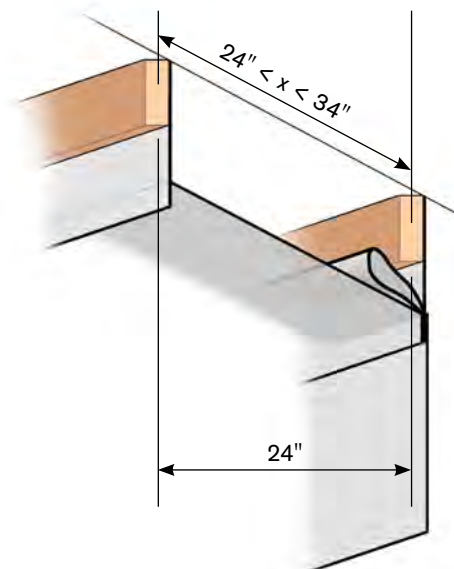



## Netting of Gable Ends and Other Vertical Surfaces

## HANG

1. The gable end approach is similar to the netting and blowing of conventional walls. The netting engineered for this application comes in 4' and 8' widths. This is the same material that is used for the roof netting. **Do not use regular wall netting as it has not been tested to meet the requirements of this application.**
2. Before starting, ensure that the cavity formed by exterior sheathing and the framing satisfies the R-value requirements (e.g., a minimum of 3" is required to achieve R13). This can be accomplished when the 2 x 4" framing is faced perpendicular to the house or if there is double 2x4 framing with the 2 x 4's facing the interior. If these conditions are not met, work with the builder to rectify before continuing work on the gable ends
3. Starting from one side of the eave, **unroll** the product along the face of the gable
4. Moving across the gable, fasten to the framing via staples every 3"

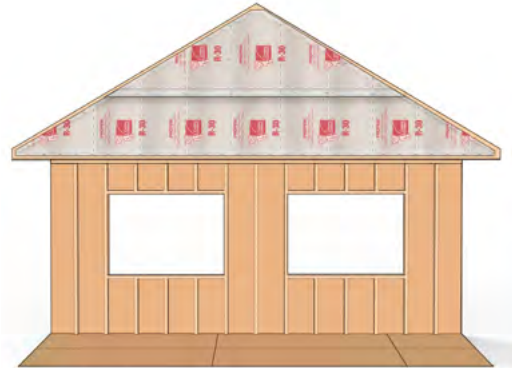
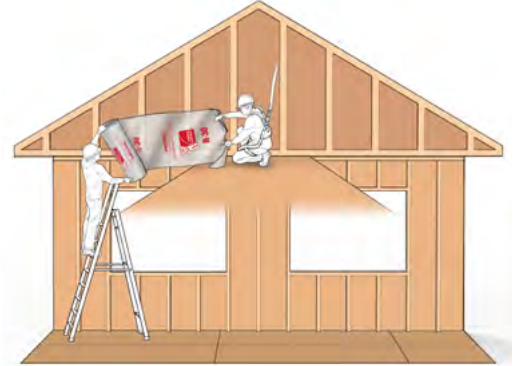
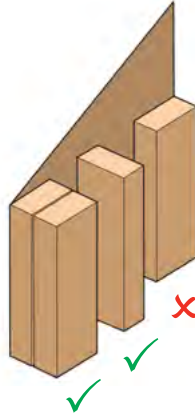

## INTERFACE

1. At the area where the roof deck meets the gable end or another vertical surface, it is suggested that the regular netting be hung from the roof deck with the 24" flap facing away from the gable.
2. **Staple** the anchor of the netting to the gable end where possible
3. Similar to narrow width bays, bunch up the extra netting from the roof deck material, and **position** next to the material from the gable end
4. **Connect** the netting hanging from the deck to the netting at the gable end. Apply staples a maximum of **3" apart**

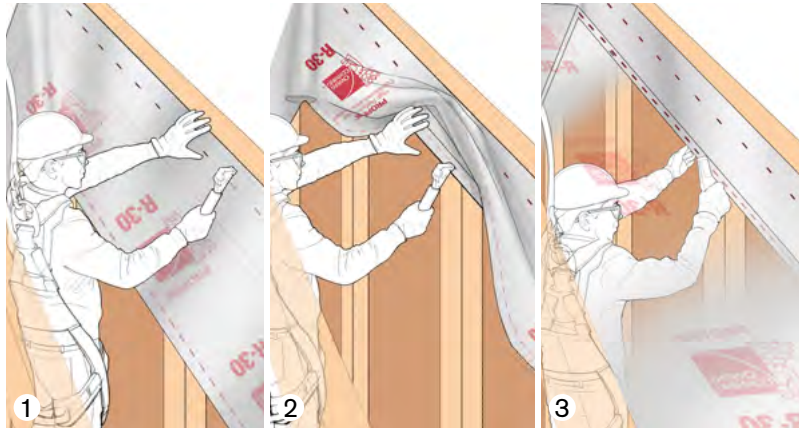

# Insulation Installation



## Job Checklist

- Owens Corning® ProPink® Loosefill Insulation
- Owens Corning® ProPink One® Foam Sealant cleaner and dispensing gun (for any last minute air sealing)
- Owens Corning® ProPink™ Netting (for any last minute netting repair)
- Hammer stapler and staples (for any last minute netting repair)
- Blowing machine with hose
- Ladder
- Utility knife
- EcoTouch® Unfaced FIBERGLAS™ Batt Insulation

## SAFETY

### Installation of the Insulation

These instructions are only a summary guide for installing insulation as part of the ProPink® High Performance Conditioned Attic System. Installation should not be attempted without the appropriate training. See general safety recommendations on page 3. Refer to the product package and product Safety Data Sheet for additional safety information. The process of blowing insulation into enclosed cavities is best accomplished with two people.

### Fire Hazard

To prevent fire or overheating of recessed light fixtures or similar electrical devices, do not insulate within 3" of such devices unless they are specifically approved to be covered by insulation. Do not place insulation in air spaces surrounding metal flues, chimneys, or fireplaces. Provide minimum clearances specified in NFPA-31, NFPA-54, or NFPA-211, or as required by local building codes.

## BLOWING INSTRUCTIONS

Only use Owens Corning® ProPink® Loosefill Insulation for this application.

### Final Air Sealing & Netting Repair

Prior to blowing the insulation, inspect the entire roof deck for any remaining penetrations that need to be air sealed or damaged netting that needs to be repaired.

### Hose Setup

Owens Corning recommends the use of 3" hose for this application. Attach to the blowing machine and insert the other end into the cavity.

### Filling a Cavity

1. Near the roof ridge, cut a slit large enough to insert the blowing hose in the netting. Insert the hose behind the netting and slide the hose down the netted cavity to the eave.
2. Turn on the blowing wool machine.
3. Retract the hose slowly toward the entry point as the material fills. The netting will tighten and bulge slightly as the insulation is blown in and the hose is withdrawn.
4. Once the hose end reaches the opening in the netting, turn off the blowing wool machine and redirect the hose to slide it down the netted cavity to the opposite eave. Repeat steps 2 & 3.
5. Point the hose at the top of the cavity until the cavity is completely filled.

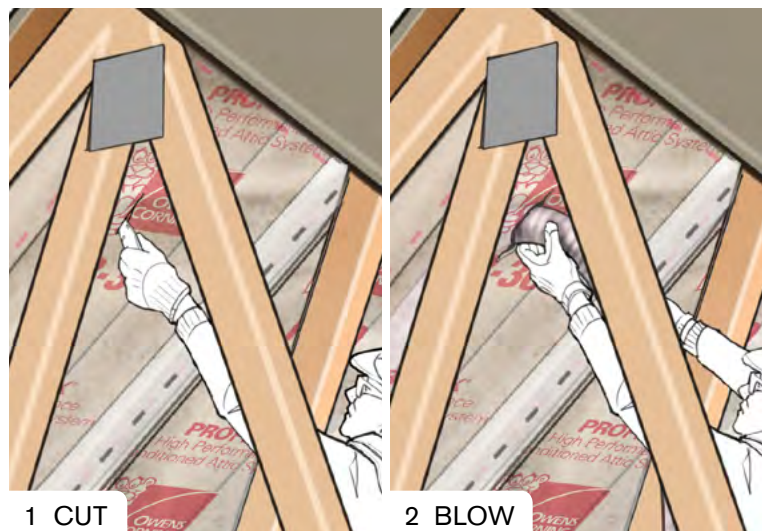

6. Turn off the blowing wool machine.
7. Inspect the cavity for unfilled areas. These areas can be seen as lighter colored areas behind the netting. Cut a new slit, insert the hose, and turn on the blowing machine until full. Be sure that the cavity is of uniform color and shape before moving to the next cavity.
8. Plug any netting holes with a wadded piece of unfaced fiberglass batt insulation.



8 PLUG HOLES WITH UNFACED BATT INSULATION

## COVERAGE CHART

Use the chart below to determine the required number of bags. Stated R-value is achieved by installing the minimum required number of bags per 1,000 sq. ft. at a thickness not less than the stated minimum thickness. Failure by the installer to provide both the required number of bags and at least the minimum thickness will result in lower insulation R-value.

R-value	Cavity Depth [in]	Minimum Installed Density [lbs/cu ft]	Maximum Coverage [sq ft/bag]	Bags per 1000 sq ft	Minimum Weight [lbs/sq ft]	Length of 24" Truss Bay per Bag* [ft]
22	5.50	1.3	55.4	18.1	0.596	27.7
30	7.50	1.3	40.6	24.6	0.813	20.3
38	9.50	1.3	32.1	31.2	1.029	16.0
49	12.25	1.3	24.9	40.2	1.327	12.4

\*The Owens Corning logo that is printed on the netting could be used for measurement. It is repeated every 4 feet.

### Density Assurance (Primary):

At the beginning of the installation process and periodically throughout, it is recommended that the density of insulation in the cavity be determined in order to confirm R-value.

- a) Allow the blowing machine to empty out.
- b) Add one bag of ProPink® Loosefill Insulation to the blowing machine.
- c) Select an uninstalled, standard-width truss cavity (24").
- d) For the desired R-value, use the coverage chart shown above to find the maximum length of truss bay that should be filled per bag (e.g., one bag will fill 20.3 feet of a truss cavity at the correct density to achieve R-30).
- e) Measure this distance along the selected truss cavity and make a mark on the netting. Alternatively, the Owens Corning logo that is printed on the netting could be used for measurement. It is repeated every 4 feet.
- f) Blow material into the cavity as described above (see Filling a Cavity) until the blowing machine is empty.
- g) If the filling length has exceeded the distance mark on the netting, the density is too low. If the filling length has not reached the distance mark on the netting, the density is too high.

### Density Assurance (Alternate):

An alternative to the above method is to remove the insulation from a filled cavity and weigh it.

- a) Identify a filled cavity for measurement.
- b) Mark two lines on the netting across the width of the cavity, where the lines are separated by 24".
- c) With a sharp utility knife, cut the netting along the lines and allow the insulation to empty into a bag or box.
- d) Weigh the material on a scale that displays weight in tenths of a pound.
- e) Divide the weight by 4. This is the area weight in lbs/sq ft.
- f) Compare this value to the Minimum Weight [lbs/sq ft.] listed in the coverage chart.
- g) Patch the opening with new netting and re-blow.



**OWENS CORNING INSULATING SYSTEMS, LLC**  
ONE OWENS CORNING PARKWAY  
TOLEDO, OHIO, USA 43659  
**1-800-438-7465 (1-800-GET-PINK®)**  
**[www.owenscorning.com](http://www.owenscorning.com)**

Pub No. 10019449-B. Printed in U.S.A. August 2015. THE PINK PANTHER™ & © 1964–2015 Metro-Goldwyn-Mayer Studios Inc. All Rights Reserved.  
The color PINK is a registered trademark of Owens Corning. © 2015 Owens Corning. All Rights Reserved.  
Patent Pending System and Components.